

CODE/ADDENDA 2007/A08 APPROVED
 RELEASED FOR PRODUCTION
 Q.C. _____ DATE _____

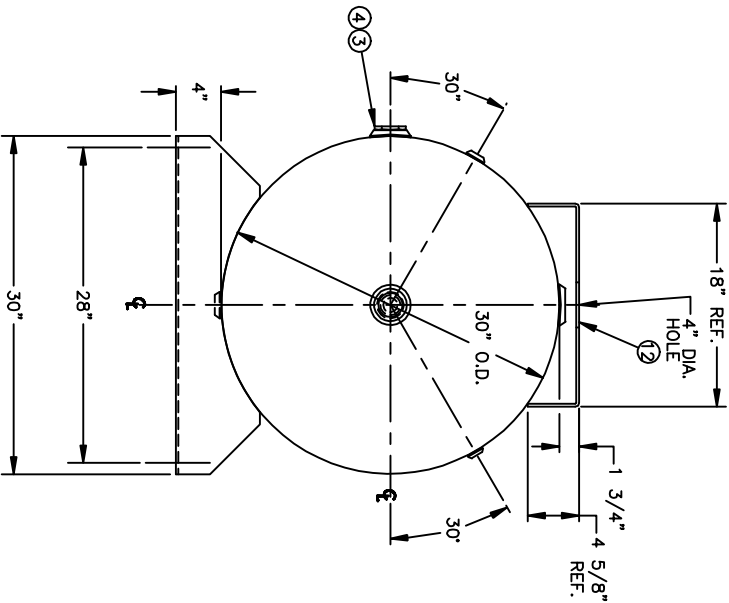
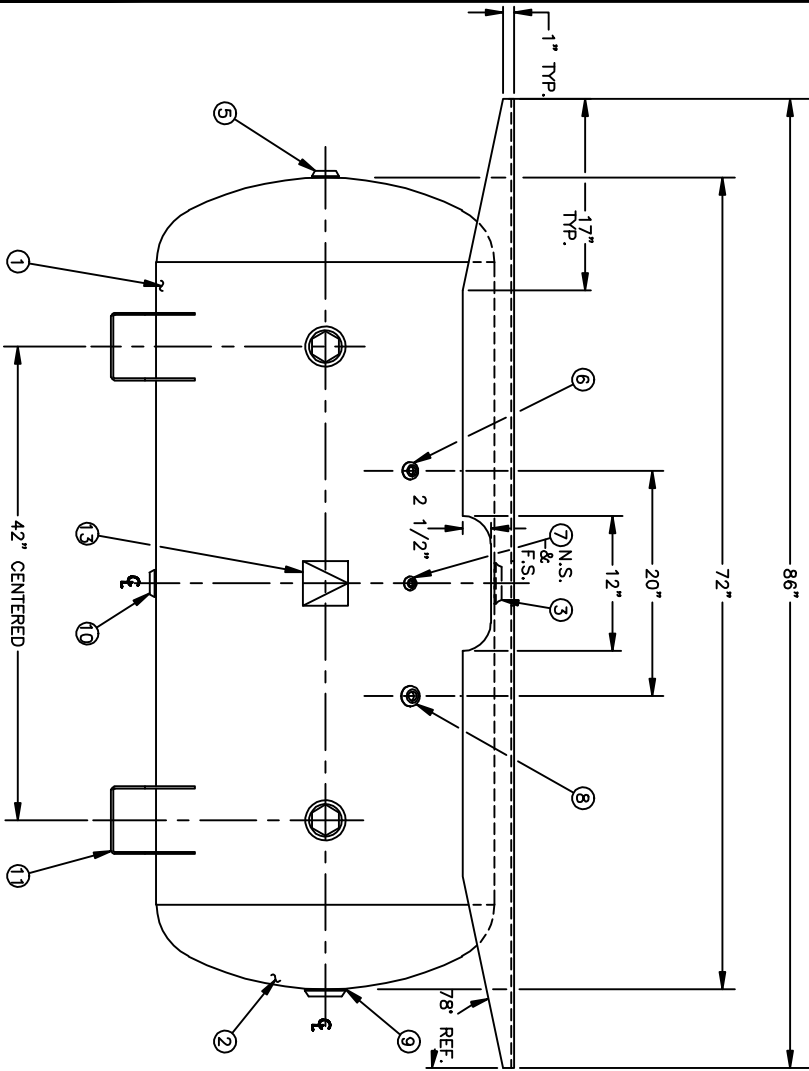

NO.	QTY	DESCRIPTION	SPEC	SUB-DWG.
3	3	2"-NPT 1500# RADIAL FLANGE	SA-181-70	
4	2	2"-NPS PLUG	SA-181-70	
5	1	1"-NPT 1500# FLAT FLANGE	SA-181-70	
6	1	3/8"-NPT 1500# FLAT FLANGE	SA-181-70	
7	2	1/4"-NPT 1500# FLAT FLANGE	SA-181-70	
8	1	1/2"-NPT 1500# FLAT FLANGE	SA-181-70	
9	1	2"-NPT 1500# FLAT FLANGE	SA-181-70	
10	1	1"-NPT 1500# RADIAL FLANGE	SA-181-70	
11	2	STANDARD SADDLE FOR 30" DIA.	AS0103	
12	1	1/4" X 26 1/4" X 86" PLATFORM	C1010	
13	1	ASME DATA PLATE	C1010	

SYN DATE / BY

REVISION

APP

NOTES

SPECIFICATIONS



200 GALLON
 STD. HORIZ. W/EXTENDED PLATFORM

Q.D. 30 LGTH. 72
 WAMP 200 PSI @ 650 F.
 GAL. 200
 WT. 700#
 CORR ALW --- SH --- HD
 CODE ASME SECT.VIII, DIV.1
 PER DATE OF DWG/LAST REV
 CRN. F0628.1C
 WELD DETAILS: M-1932
 STD. TOLERANCES (UNLESS OTHERWISE NOTED): M-2461

SCALE: NONE
 DRAWING NO. 302701